

May 5, 2017

Johnson Tract
Sketch Map

Westmoreland Co

± 64½ acres

Harvestable Timber

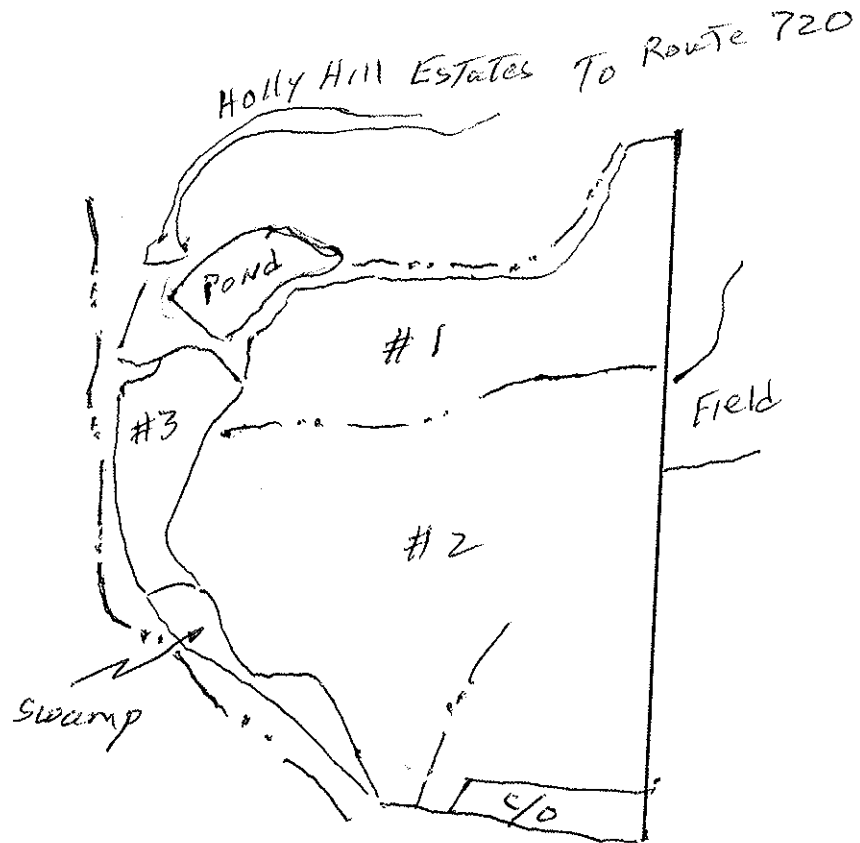
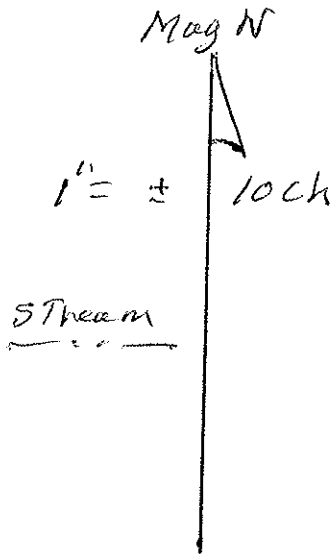

Richard C. Shelton

May 2017

Johnson

Westmoreland Co. VA

Stand #1

Estimated Volumes for International 1/4" Kerf Rule Measure

D.B.H	Pine	Poplar	Red Oak	White Oak
10	-	-	-	-
12	1,523	3,610	1,523	3,046
14	3,271	6,420	2,613	11,816
16	-	8,479	-	6,777
18	7,031	2,782	9,372	10,067
20	-	4,700	-	8,093
22	-	9,832	6,655	12,352
24	-	-	8,845	-
26	-	-	2,726	-
28	-	-	5,678	-
T:	11,825'	35,823'	37,412'	52,151'

Ches. Oak = 24,553'

Mixed Hdw = 12,455'

Pine P.W. = 7 CDS

Hdw P.W. = 78 CDS

Total Vol. = 174, 219'

Est. Acres = 16

AVG. Vol./Ac = 10,889'

Cruised by David Sheldon

Appraised by Sidney Sheldon

Pine: 12m @ \$120 = \$1,440

Poplar: 36m @ \$200 = \$7,200

Red Oak: 37m @ \$200 = \$7,400

White Oak: 52m @ \$250 = \$13,000

Ches. Oak: 24m @ \$150 = \$3,600

Other Hdw.: 12m @ \$100 = \$1,200

Pine P.W.: 7 CDS @ \$20 = \$ 140

Hdw. P.W.: 78 CDS @ \$6 = \$ 468

Total = \$34,448

May 2017

Johnson

Westmoreland Co. VA

Stand #2

Estimated Volumes for International 3/4" Kerf Rule Measure

D.B.H	Pine	Poplar	Red Oak	White Oak
10	92,476	-	-	-
12	201,788	4,319	-	659
14	165,249	4,502	939	1,818
16	84,729	8,247	-	-
18	17,348	15,567	2,196	-
20	12,155	-	4,124	-
22	-	-	-	-
24	-	3,062	-	-
T:	573,705'	35,697'	7,259	2,477'

Mixed Hdw = 5,063'

Pine P.W. = 516 CDS

Hdw P.W. = 92 CDS

Total Vol. = 624,201'

Est. Acres = 44

AVG. Vol./Ac = 14,186'

Cruised by David Sheldon

Appraised by Sidney Sheldon

Pine: 574m @ \$120 = \$68,880

Poplar: 36m @ \$150 = \$ 5,400

Red Oak: 7m @ \$150 = \$ 1,050

White Oak: 2m @ \$150 = \$ 300

Pine P.W.: 516 CDS @ \$20 = \$10,320

Hdw. P.W. 92 CDS @ \$6 = \$ 552

Total \$86,502

Sidney C. Sheldon

May 2017

Johnson

Westmoreland Co. VA

Stand #3

Estimated Volumes for International ¼" Kerf Rule Measure

Maple = 15,993'

Hdw. P.W. = 13 CDS

Total Vol. = 15,993'

Est. Acres = 4

AVG. Vol./Ac = 3,998'

Cruised by David Sheldon

Appraised by Sidney Sheldon

Maple: 16m @ \$120 = \$1,920

Hdw. P.W.: 13 Cds @ \$6 = \$ 78

Total = \$ 1,998

